

---

Design No. BTC/WA 60-01  
Loadbearing Wall Assembly  
Barrier Technologies, Corporation  
Blazeguard® Sheathing  
ASTM E-119  
Assembly Rating-1 hour  
Superimposed Test Load - 2,145 lb/stud

---

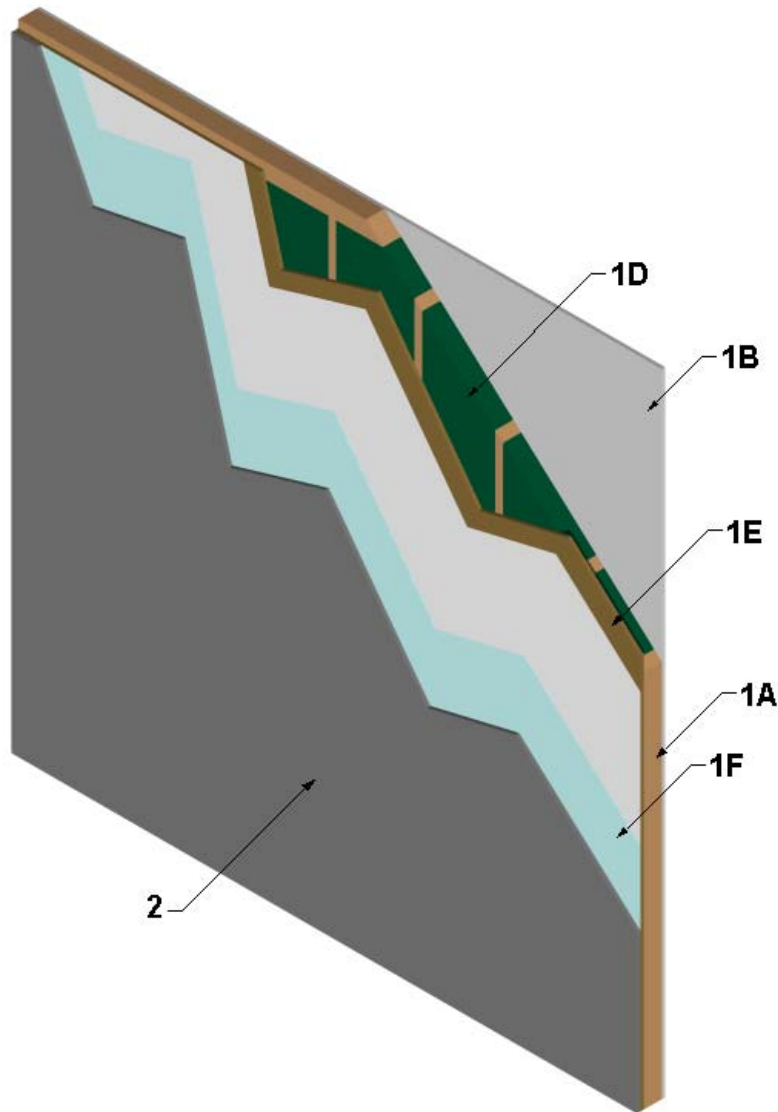

1. WALL ASSEMBLY: Construct a 1 hour rated gypsum wall assembly using the following elements:

A. WOOD STUDS: Install nominal 2 in. x 6 in., Number 2 Douglas Fir wood studs spaced 16 in. on center.

Attach each wood stud to top and bottom wood plates using three (3) 16d framing nails at each location. Construct top plate of two (2) wood studs installed horizontally at the top of the gypsum wall assembly and the bottom plate of a single wood

stud. Install nominal 2 in. x 6 in. wood studs horizontally as cross-bracing positioned at mid-height of the wall.

B. GYPSUM BOARD: Install one layer of nominal 5/8 in. thick Type X gypsum board, oriented vertically. Secure gypsum board using nominal 1-7/8 in. long cup-head drywall nails spaced nominally 8 in. on center

C. Joint Tape and compound (Not shown): Install vinyl or casein, dry or premixed joint compound applied to exterior face of gypsum board in two coats to all exposed fastener heads and gypsum board joints. Install minimum 2 in. wide paper, plastic or fiberglass tape embedded in the first layer of compound over joints in gypsum board.

D. INSULATION: Install nominal 5-1/2 in. thick, nominal 2.5 pcf density unfaced mineral fiber batt insulation friction fit between the wood studs (Item 1A).

E. CERTIFIED MANUFACTURER:  
Barrier Technologies Corporation

CERTIFIED PRODUCT: Wood Sheathing, Fire Retardant Coated Sheathing

MODEL: Blazeguard® (Direct Applied, Plywood) or Blazeguard® (Direct Applied, OSB)

Install nominal 48 in. wide x 96 in. tall, nominal 15/32 in. minimum thick Blazeguard® (Direct Applied, Plywood) or nominal 7/16 in. minimum thick Blazeguard® (Direct Applied, OSB) sheathing with the white side facing out. Install sheathing staggered at gypsum seams. Secure sheathing to wood studs (Item 1A) using 1-7/8 in. long

6d nails spaced 6 in. on center around the perimeter and 12 in. on center in the field.

F. VAPOR BARRIER: Install Tyvek ® HomeWrap ® vapor barrier fastened over the sheathing (Item 1E) using sufficient fasteners to prevent air pockets in the wrap.

2. EXTERIOR WALL COVERING: Install one of the following items on the exterior side of the wall assembly (Item 1):

A. STEEL SIDING: Install nominal 38-1/2 in. wide x 10 ft long, 26 GA steel siding with minimum 36 in. coverage. Attached siding to wood studs (Item 1A) over the vapor barrier (Item 1E), using 1-7/8 in. long self tapping drywall screws, two per panel per stud.

B. T1-11 SIDING: Install minimum 5/16 in. thick plywood or OSB siding per the manufacturer's published installation instructions.

C. FIBER CEMENT BOARD: Install minimum 5/16 in. thick cellulose fiber-reinforced cement board per the manufacturer's published installation instructions.

D. WOOD FIBER PANEL: Install minimum 5/16 in. thick zinc borate coated wood strand or wood fiber panel per the manufacturer's published installation instructions.